

Gateway Arch National Park Photography Guide



Gateway Arch National Park

Photography Guide

Welcome to Gateway Arch National Park, where history, architecture, and nature come together in one iconic setting! Whether you're an amateur with a smartphone or an aficionado with all the hi-tech gear, this urban oasis is the perfect spot for your next photoshoot.

In this guide, we'll take you to our top 5 favorite photo locations around the Arch grounds and highlight the creative angles and positioning that will make your shots stand out.

To start, let's go over two key tips that will make all the difference in your photos:

1. Try, try again – Take as many different photos as you can to ensure you take home one that you know you'll like.
2. Let loose – The best photos capture natural laughter and expressions. Instead of your typical pose, try snapping a pic after telling your go-to joke.



Location: North Reflection Pond

See the Gateway Arch emerge from the treetops as the perfect backdrop for your photos.

Pro tip! Angle your camera to capture reflections across the water.



Location: Visitor's Center

Capture that feeling of seeing the Arch up close for the very first time as you approach the Visitor's Center

Make it wide! Get low and zoom out to include the Arch in your shot.

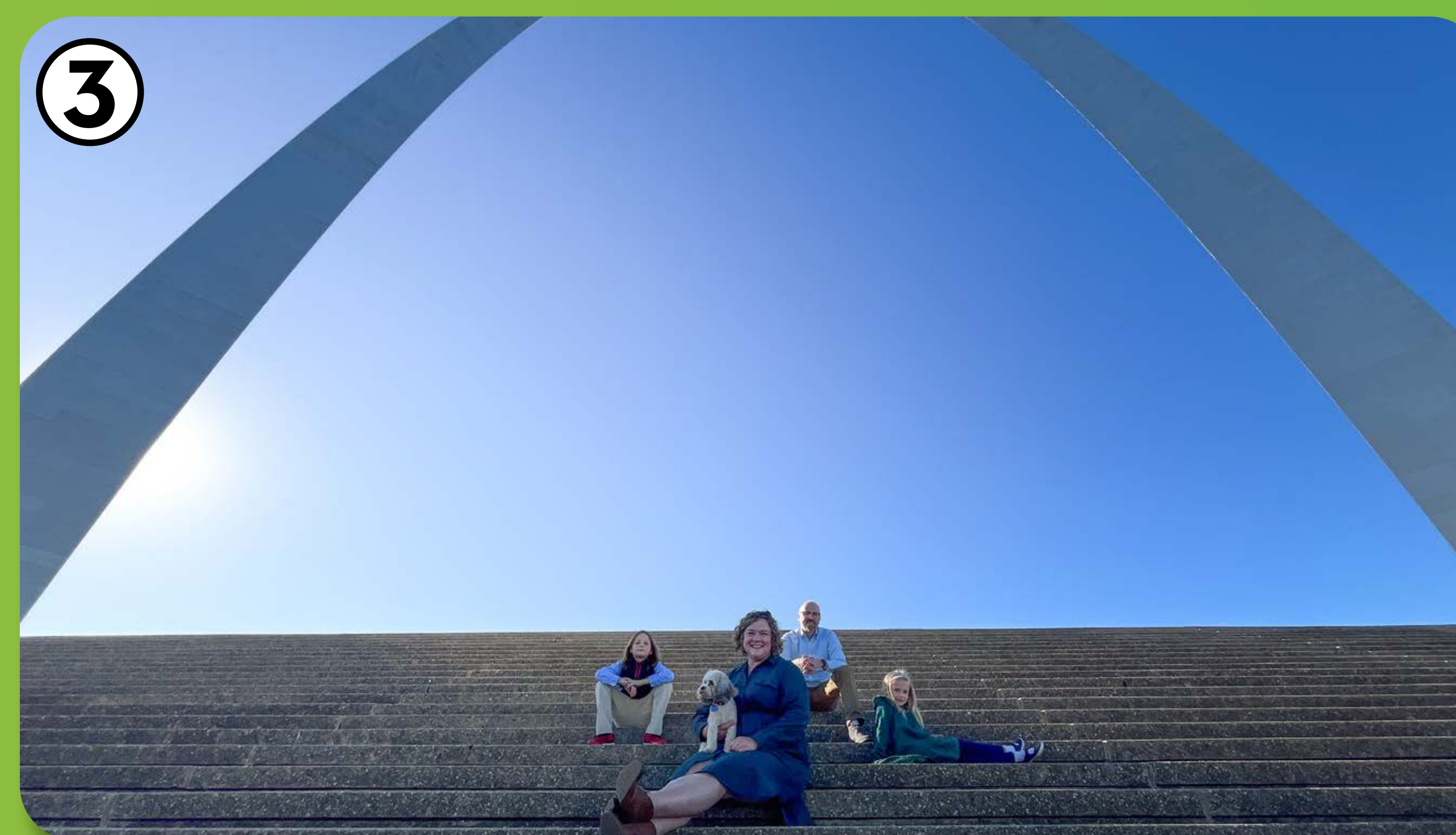

Location: Grand Staircase

Find the perfect low-angle shot to showcase the grandeur of North America's tallest monument.

Get creative! Position your subjects on different stair levels to add dimension.



Location: South Reflection Pond

Emphasize the natural beauty of Gateway Arch National Park at the southernmost corner of the reflection pond.

Fun fact! Geese, ducks, and other park critters love to photobomb in this spot.



Location: South Overlook

Display the river, park, and city skyline that defines everyone's introduction to St. Louis

Add to your shot! Structures like the Ead's Bridge can greatly elevate the quality of your backdrop.

Pave Your Own Photography Path

The best part of any photoshoot is the unexpected gems you find along the way, and Gateway Arch National Park has no shortage of hidden treasures.

Make your photos stand out by perusing the park with your unique eye. As you continue exploring, you'll find even more stunning backdrops, from secluded tree coves to scenic walkways that frame the Arch in distinct ways. Don't be afraid to wander and discover your own favorite angles—there's always another picture-perfect spot waiting to be captured in and around the park!

About Us

Gateway Arch Park Foundation

We're Gateway Arch Park Foundation, the official nonprofit conservancy and philanthropic partner of Gateway Arch National Park. Our mission is to ensure the Gateway Arch, its grounds, neighboring public spaces, and attractions will be a vital, welcoming, and well-supported resource for the community and nation for generations to come.

We fulfill our mission in a variety of ways, most notably by providing conservation, preservation, education, and community programming at the Arch grounds and surrounding areas in Downtown St. Louis.

Whether it's maintaining museum exhibits at the Arch, leading our co-managed volunteer program with the National Park Service, restoring significant park sites like the Old Courthouse, or bringing thousands of guests to events like Winterfest and Blues at the Arch, our efforts are all made possible through the support of our members and donors.

Learn how you can support our mission at
archpark.org/membership



GATEWAY ARCH PARK
FOUNDATION